

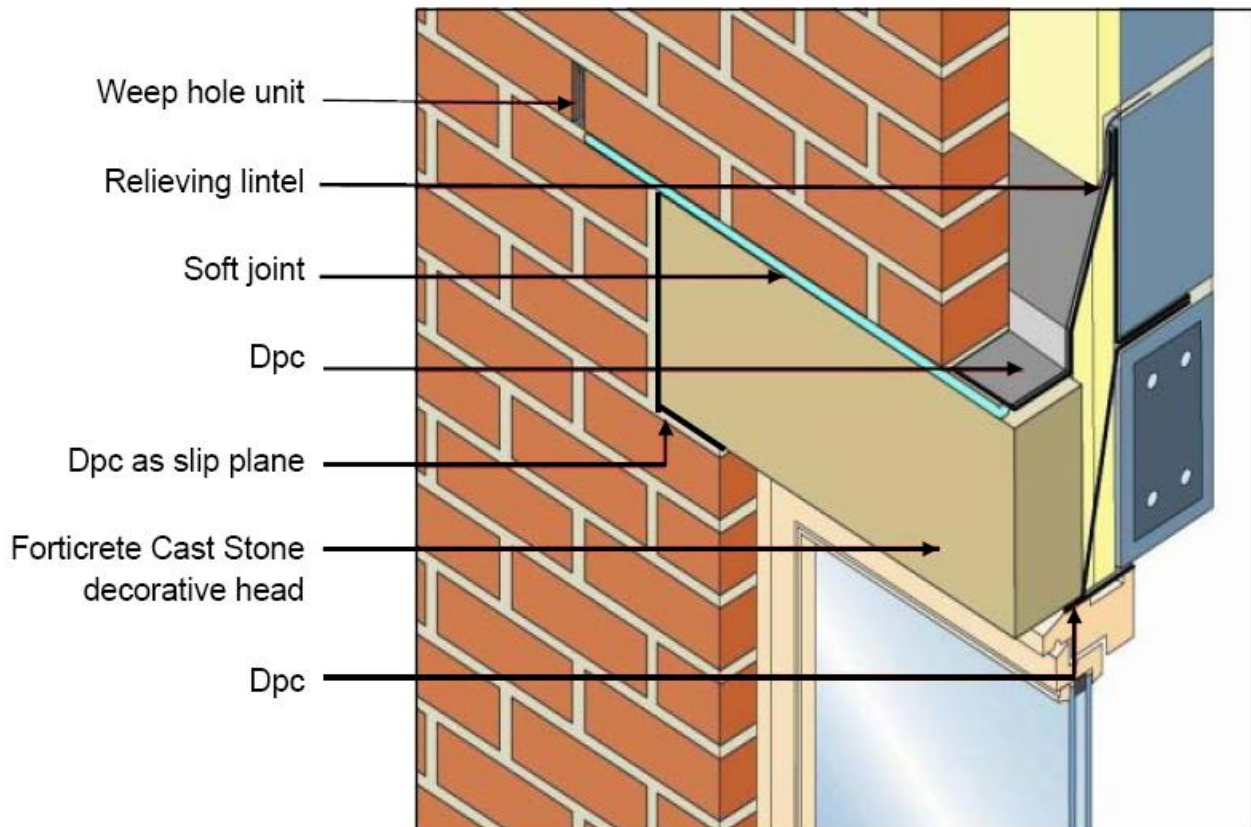

FORTICRETE[®]
innovators in walling & cast stone[™]

CAST STONE DATA SHEET 3 — STEEL RELIEVING LINTEL DETAIL
RECOMMENDED FOR ONE PIECE DECORATIVE HEADS



The soft joint below the steel lintel should allow for the maximum deflection of the steel lintel and not transfer any load on to the decorative Cast Stone lintel below.

For all Forticrete Cast Stone Products compressive grade (M2) designation (iv) mortar should be specified, but in no case should anything stronger than a designation (iii) (M4) be used. We would like to point out that this is likely to be different from that used in the surrounding brickwork. It is preferable that mortars containing lime be used as these can best accommodate movement within the structure and eliminate cracking of the Cast Stone. It is recommended that mortars are obtained from a reputable supplier e.g. CPI Euromix, Cemex and Tarmac Ltd who can supply matching coloured mortars for the majority of Forticrete products.

Helpful Hint: A recommendation to eliminate stress and differential movement, is to provide bed-joint reinforcement for two courses above and below all openings which should extend no less than 600mm either side of the opening. The dpc slip plane should be extended up the ends of the lintel to keep it separate from the surrounding brickwork.



CD Stone Products, The Brickyard, Hudcar Lane, Bury, Lancs BL9 6HD
Tel 0161 797 2643 Fax 0161 763 9367 www.central-distribution.co.uk

